

1. From the lower right corner click on "Action Center" icon (1). Then press on "VPN" (2).

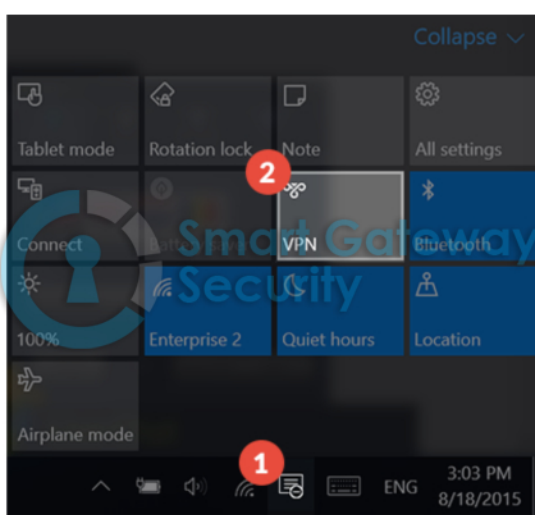

2. This will open "Network & Internet" settings window. Click on "Add a VPN connection" (3).

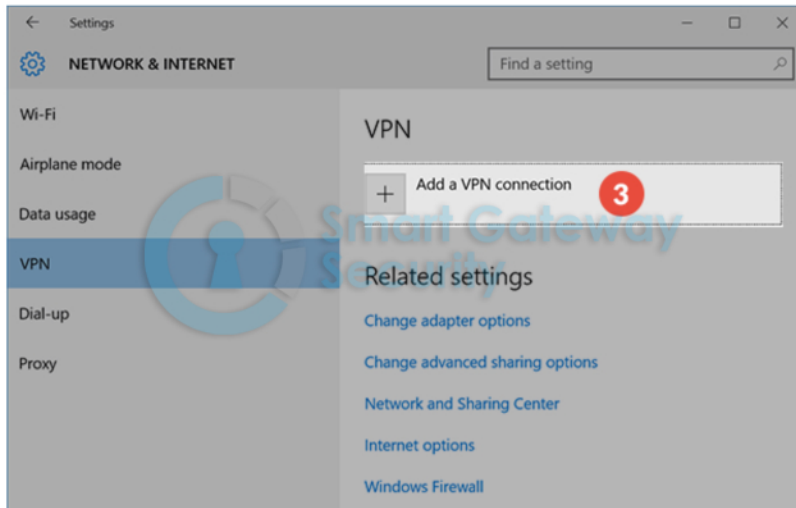

3. On the next page fill the fields with the following settings:

VPN provider – Windows (built-in) (4).

"Connection name" (5) – Give a memorable name to this connection.

"Server name or address" (6) – type server name or address you want to connect.

"VPN type" (7) – select Point to Point tunneling Protocol (PPTP).

"Type of sign-in info" (8) – select User name and password.

In the "User name" (9) and "Password" (10) fields type your VPN username and password.

Check all selected data once again and press "Save" (11).

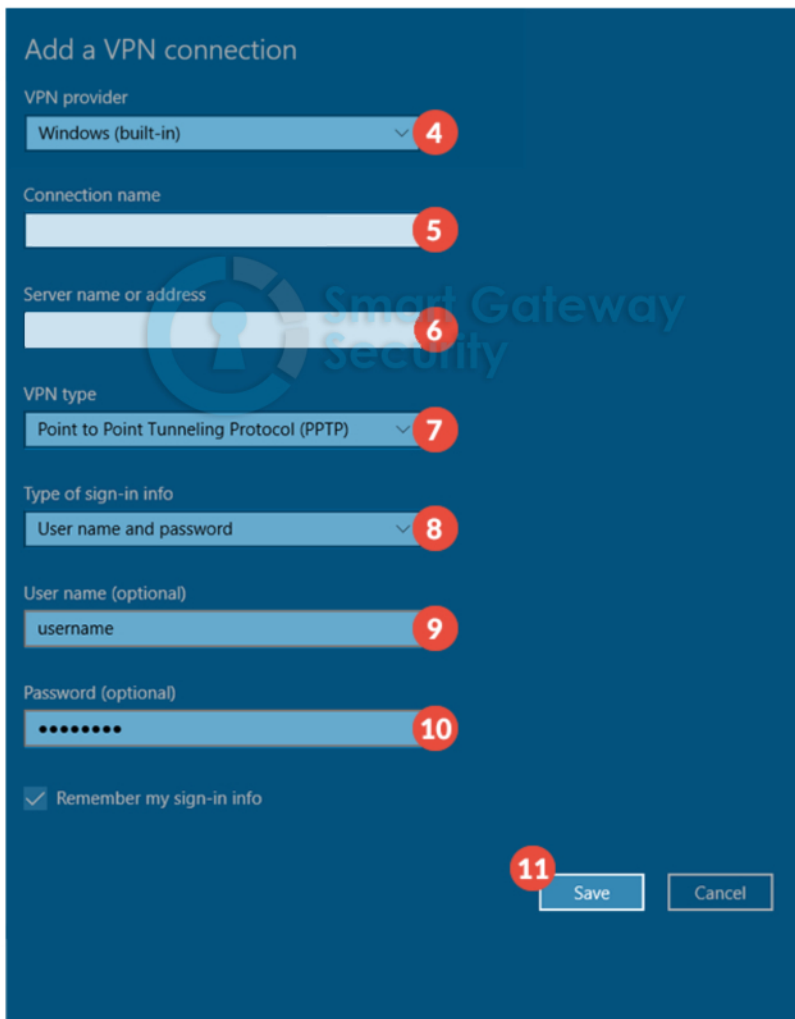

4. Now you can see your VPN connection (12) was created.

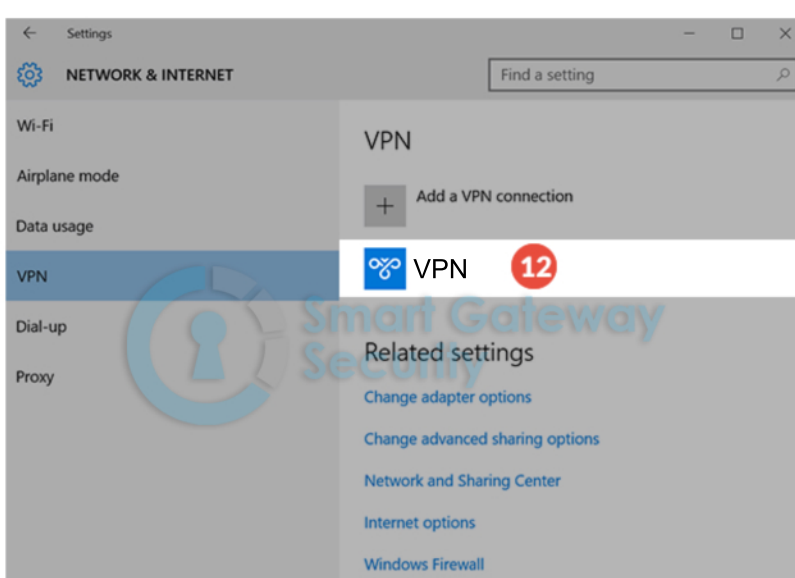

5. When you want to connect to this VPN server go to Network button and click on the VPN connection (13).

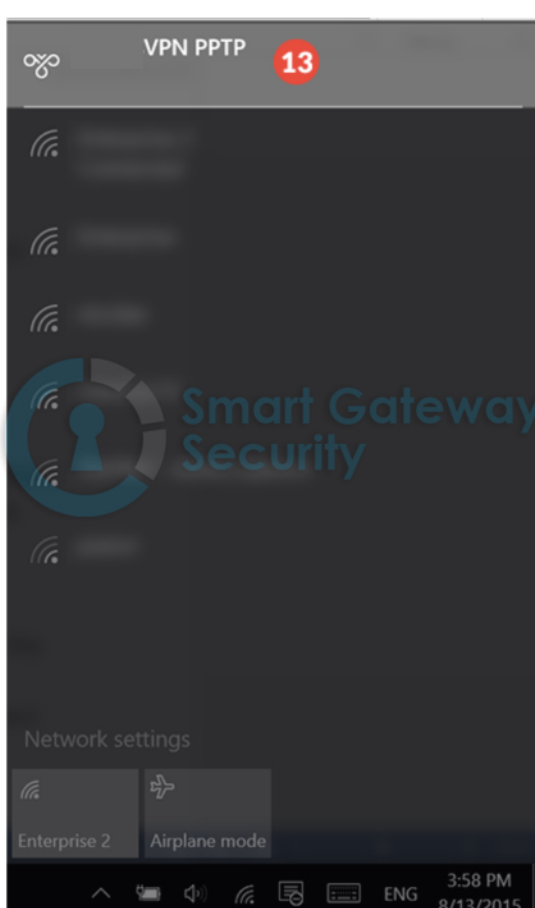

6. This will open VPN connection list. Select desired VPN server and click on "Connect" (14).

7. After a few seconds a connection will be created. To disconnect just press the "Disconnect" button (15).